

vitrum®

vitrum 100

Vitrum 100

monolith, back illuminated poster cases



Vitrum 100 is one of the range of Vitrum outdoor, back illuminated poster cases, secure, watertight and lockable. Vitrum 100 poster cases have a monolith format and are available either single or double sided.

Superbly engineered using aluminium profiles, Vitrum 100 has a contemporary styled frame with ceramic printed borders.

The 5 mm ESG toughened glass covers are top hinged using gas cylinders that allow easy access to change or update the graphics content. The toughened glass covers are secured with a unique locking mechanism which will resist all but the most aggressive vandalism.

Either fluorescent or LED back lit illumination is available.

The LED option uses just one third of the energy of traditional lighting and carries a guarantee of 50,000 hours of illumination with no servicing. The unique design of the LED sheet produces an exceptional brightness with even lighting across the entire panel which other forms of lighting cannot match.

The LED panel has its own aluminium frame which cleverly holds the image directly behind the glass producing a stunning visual effect.

vitrum®
vitrum 100

Model	Single/double sided	Accepts	Size – overall size of case (w x h x d)	Size – overall size of case including base (w x h x d)	Size – visual size (w x h)	Back lit LED illumination
V100CLPS	Single sided	CLP poster size 1185 x 1750 mm	1310 x 1880 x 143 mm	1310 x 2380 x 143 mm	1150 x 1710 mm	62 Watts
V100CLPD	Double sided	CLP poster size 1185 x 1750 mm	1310 x 1880 x 166 mm	1310 x 2380 x 166 mm	1150 x 1710	2 x 62 Watts

Key features

- Single or double sided
- Aluminium frame
- Printed ceramic white borders
- 5mm toughened glass
- Top hinged with gas cylinders
- Fluorescent of LED back lit illumination
- Mechanical pressurised locking system
- Poster holder locates graphic directly behind glass



vitrum®

vitrum 100

vitrum 100

Dimensions and specification

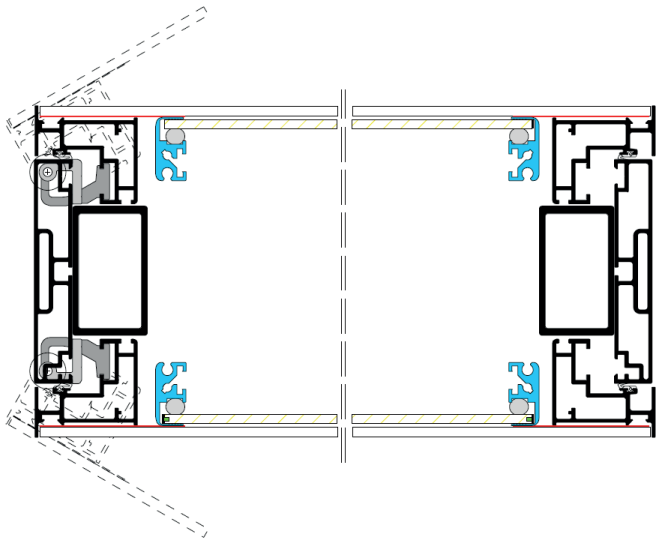
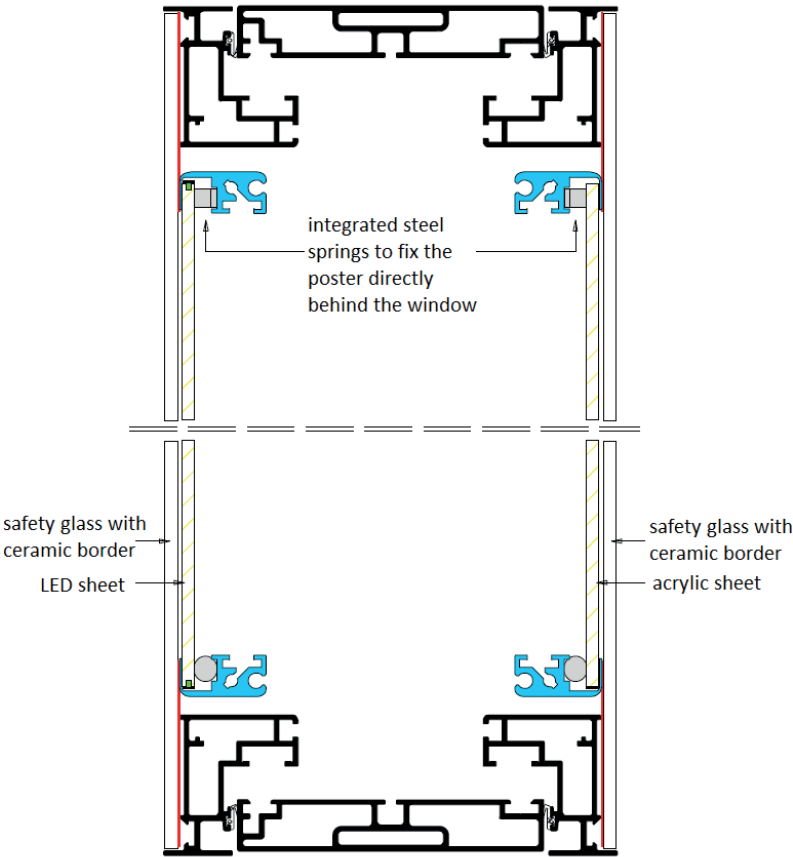

vitrum®
vitrum 100

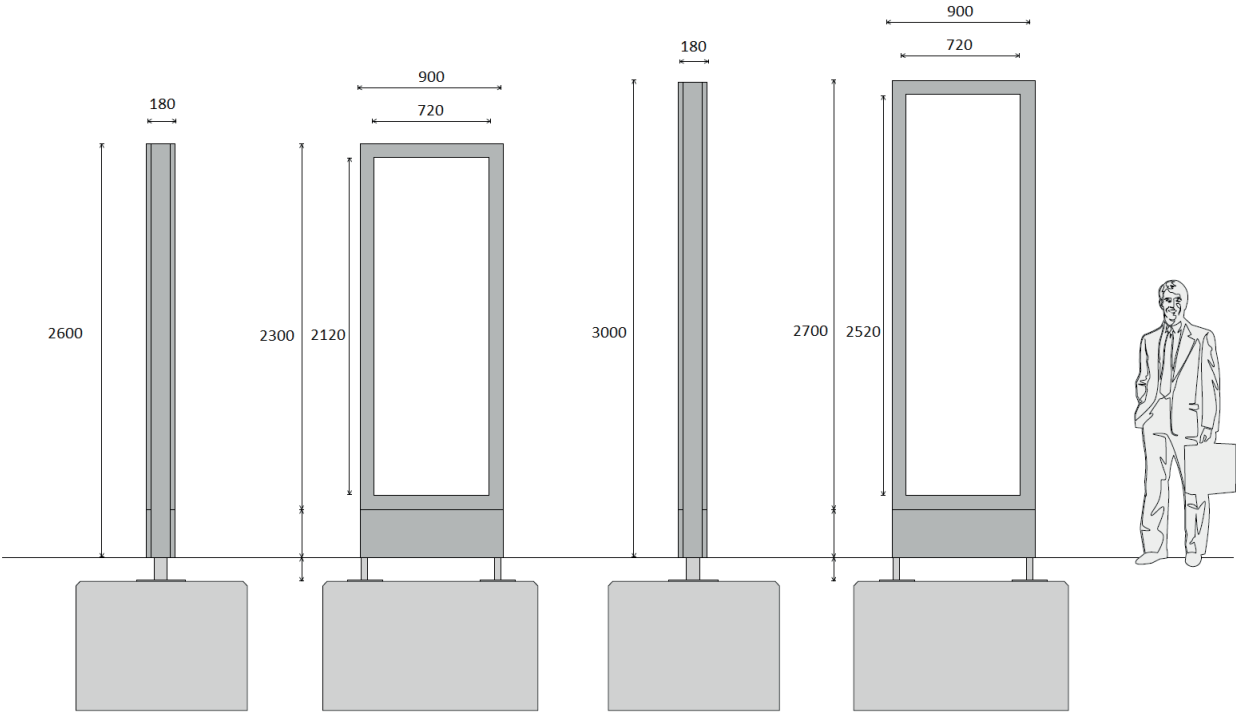

detail base plate

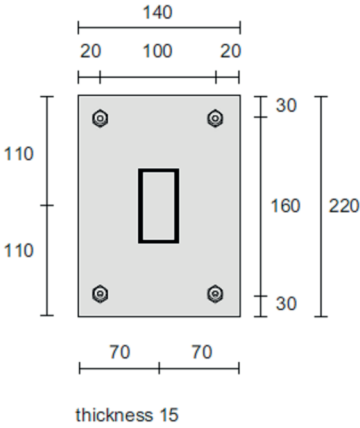

detail screw

